

Installation Guide Connect Module

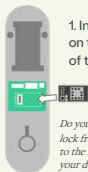

Necessary components: Connect Module, compatible nimly door lock and compatible gateway from nimly or other supported smart home vendor (not required for BLE-application)



1. Install the module on the circuit board of the inside unit.

Do you need to disassemble the lock from your door? Please refer to the installation manual for your door lock, available on our website.



2. Insert all batteries into the lock.

Make sure the batteries are installed correctly and verify that the lock is operational.

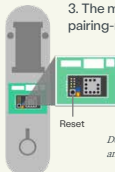

3. The module will automatically enter pairing-mode for four minutes

Pairing-mode is indicated by slow flashing on both the blue and orange LED.

Do you need to start pairing mode again? Remove and re-insert the batteries.



BLE

4. Select your preferred application by nimly or other supported smart home vendor.



CONNECT

Proceed by installing the application from either Google Play or Apple App-store and follow the pairing sequence provided in the application.



5. Successful pairing is indicated by solid light on either the blue (BLE) or orange (Zigbee) LED

Do you need to reset your module? Hold the reset button for up to 15 seconds, release when the LED starts blinking rapidly.



Need more information?
Scan to read more about our ConnectModule on our website!



Do you need assistance?
Scan to get in touch with customer support